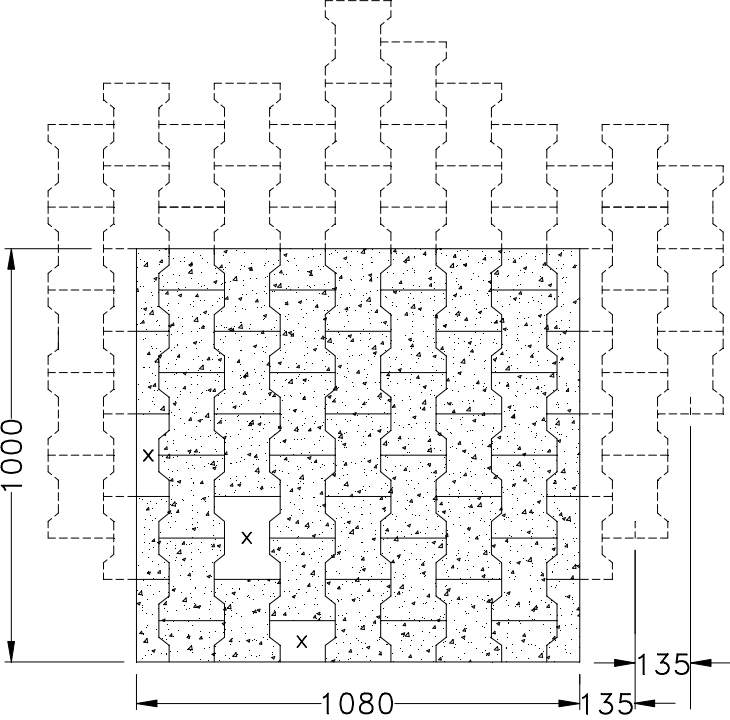
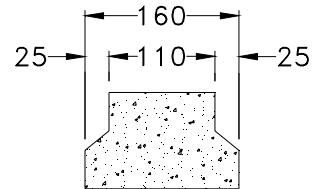
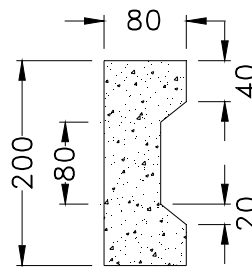

Installation and working instructions

Regupol interlocking pavers

1. Preparation	<p>The installation of Regupol®-interlocking pavers is carried out, just like the installation of normal concrete pavers, on a frost-proof, well compacted subbase or crushed stones with a levelled sand or gravel bed. the joints of the pavers are pointed with sand and vibrated with a vibrator and can be combined with commercial Behaton concrete paver. A border kerb stone is just as necessary as it is with conventional pavers - for this purpose the Regupol®-border elements made out of the same recycling rubber material is ideal.</p>
1. 1 Installation	<p>On a concrete or asphalt underground with already existing border kerb stones the pavers can be installed either loose or glued on the ground as well. A light slope of the underground of 1,5 - 2,0 % for drainage shall be considered. Regupol®-pavers in thickness 21 mm have to be adhered to a concrete or asphalt base.</p>
1. 1. 1 Graphic finished surface	

1.1.2 Graphic „Half“**1.1.3 Graphic „Beginners“****2. Installation in curves of walkways “Odenwälder Verband”**

In this case the cross connection is being dissolved and the pavers are installed by using half pieces in several narrow lines with differing joint widths.

2. 1 Installation in a radius from 8 metres

This procedure can be used for a radius from 8 metres (left handed drawing) whereas the width of the lines should not exceed 2 normal pieces and 1 half piece (approx. 50 cm).

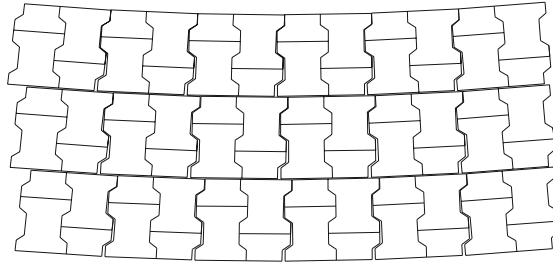
**2.1.1 Graphic Installation
in a radius from 8 metres****2.2 Installation between
4 and 8 metres**

Curves with a radius between 4 and 8 metres (right handed drawing) are exclusively carried out in lines with 2 half pieces.

**2.2.1 Graphic between
4 and 8 metres**